

# PLUGS

Ex d, Ex e, Ex t, IP65/66/67/68

for INDUSTRIAL and Ex de I/II/IIIC

**MOFLASH**  
BIRMINGHAM, ENGLAND  
SIGNALLING



## Features and Benefits

- Precision manufactured from high quality brass (marine grade electroless nickel plated) or stainless steel.
- Converts mismatching threads to the required thread.

## Technical Data

Type:	Plug
Material:	Brass (Marine Grade Electroless Nickel Plated), Stainless Steel

## Standards and Certifications

Equipment Protection Levels: Ex d I/IIc MbGb, Ex e I/IIc MbGb, Ex tb IIIC Db, IM2/II2GD

Ingress Protection - Parallel: IP66/67/68 (2m cont.)

Ingress Protection - Tapered: IP65 (NPT)

Certification:		Standard:
IEC Ex	IECEx ITA 13.0005X	IEC 60079-0, IEC 60079-1, IEC 60079-7, IEC 60079-31
ATEX	CML15ATEX1040X	EN 60079-0, EN 60079-1, EN 60079-7, EN 60079-31
INMETRO	TÜV 15.0485X	ABNT NBR IEC 60079 Parts 0, 1, 7 ABNT NBR IEC 60079 Parts 31
Chinese	CNEEx 09.0916U	GB 3836.1, GB 3836.2, GB 3836.3, GB 12476.1
SANS/SABS/IEC	MASC MS/13-594X	IEC 60079-0, IEC60079-1, IEC 60079-7, IEC 60079-31, IEC 60529
Marine	14-SG1216922-PDA	

Manufactured by CCG Cable Terminations (Pty) Ltd

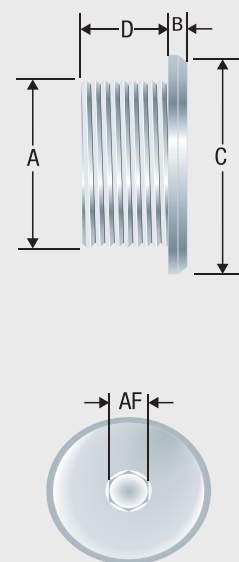

PATENTED

## Conditions for Safe Use - X

- An IP rating of IP66/67/68 is maintained for units with parallel threads when used with the supplied washer and for units with tapered thread when thread sealant is conducted as indicated in IEC60079-14. Alternatively an IP65 rating is applicable.
- A service temperature range of -20°C to 95°C is applicable if the washers are utilized to maintain an IP rating IP65/66/67/68 2m cont.
- A blanking element may not be installed on a plug.
- When the equipment with metric male thread and with the sealing washer fitted is intended for use / interface in threaded holes in a flameproof enclosure the applicable thread engagement must be achieved after the washer has been fitted. Thread engagement shall be at least five full threads.

## Plugs

	MOFLASH Product Code	Dimension 'A'	Dimension Min 'B'	Dimension Min 'C'	Dimension Min 'D'	Dimension Min 'A/F'
Brass	50204	M20	3	25	15	10
Stainless Steel	50214	M20	3	25	15	10